



**SONCEBOZ**

## ► Hybrid stepper motors

**6630-37**



**ROBUSTNESS**



**HIGH PROTECTION DEGREES**



**ACCURACY**

- **Step angle** ..... **1.8°**
- **Diameter** ..... **86 mm**
- **Weight** ..... **2800 g**
- **Holding torque** .... **6 Nm**

The hybrid stepper motor comes into its own where torque at low speed, positioning, and accuracy are determining factors.

### ► Technical data

	Part N°	Phase resistance [Ω]	Phase inductance [mH]	Phase current [A]	Holding torque [Nm]	Nominal power [W]		
Phases in parallel	6630-37-4-0.66	0.33	2.6	6.80	6	30.5	Steps/rev.	200
Phases in series		6630R203	1.32	10.4	3.40	6	30.5	Step accuracy
							Rotor inertia	2660 gcm <sup>2</sup>
							Insulation class	B 130 °C
							Protection	DIN 40050 IP 30
							Test voltage	500 VAC
							Detent torque	180 mNm

### ► Dimensions

Drawing not to scale. All dimensions in mm.

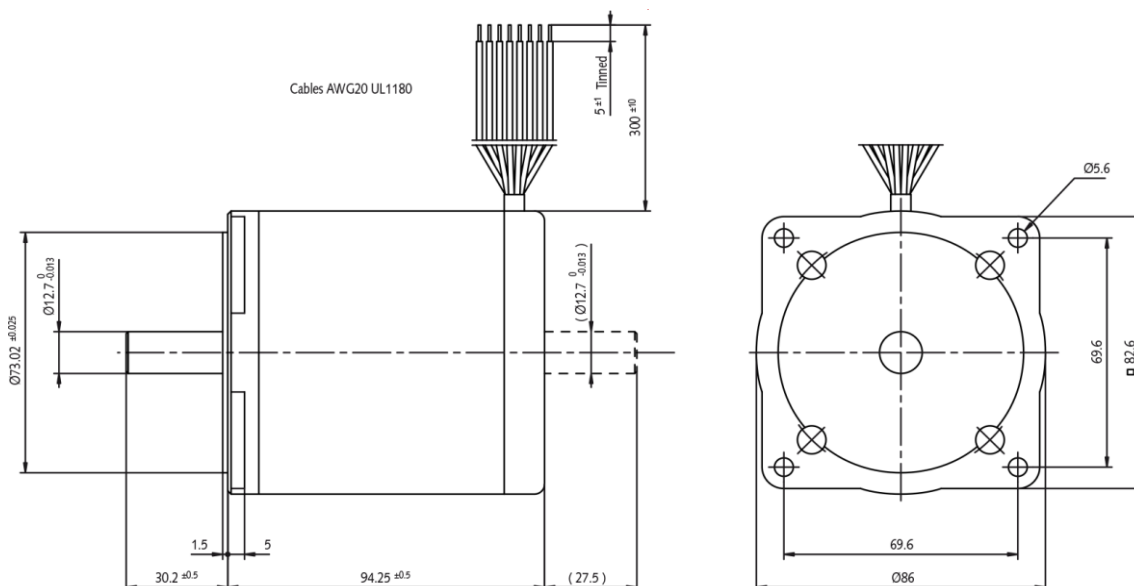

► Dynamic characteristics

• 6630-37-4-0.66 ► Phases in parallel

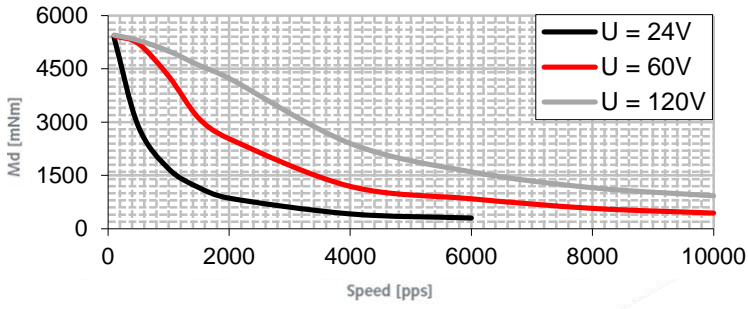

• 6630-37-4-0.66 ► Phases in series

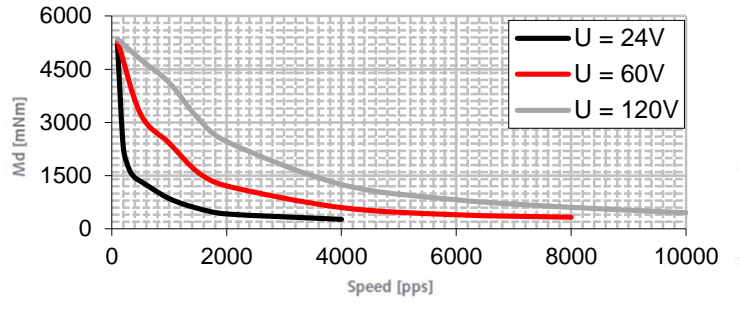

[pps] = pulses per second

► Static characteristics

• 6630-37-4 Series

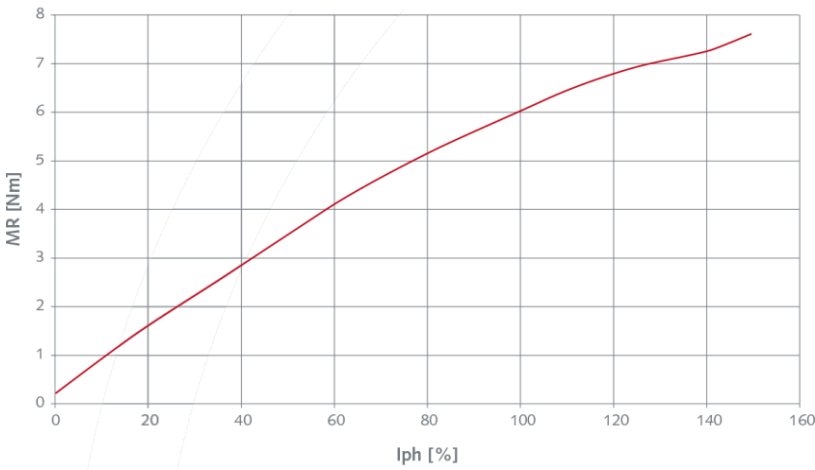

► Electrical Interface

► Phases in parallel

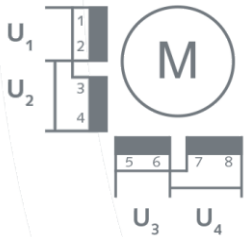

► Phases in series

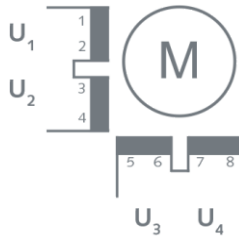

- U<sub>1</sub> 1 green  
2 orange
- U<sub>2</sub> 3 black-white  
4 green-white
- U<sub>3</sub> 5 red  
6 black
- U<sub>4</sub> 7 white  
8 red-white